

AERODROME
CHART - ICAO

AD ELEV 174FT
VAR 5°E (2020)

APP 120.225
129.875
TWR 125.550
ATIS 126.225

ARP COORD
43° 16' 58.44" N
017° 50' 45.16" E

MOSTAR (LQMO)

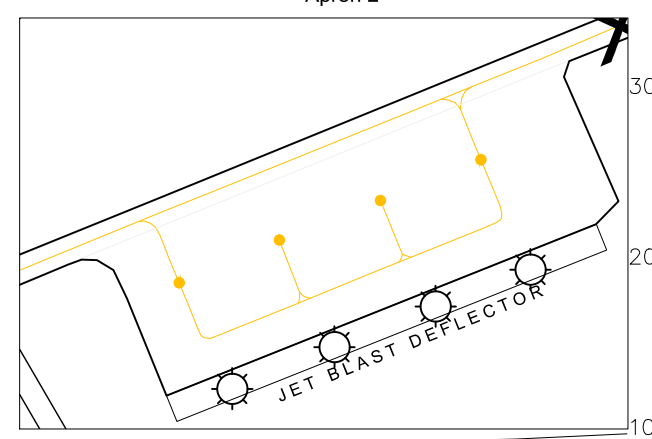
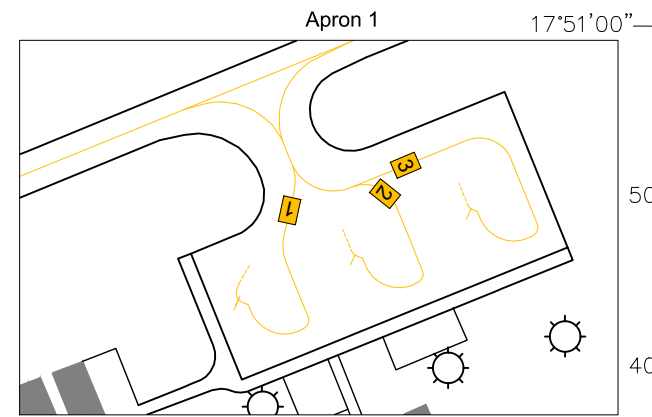
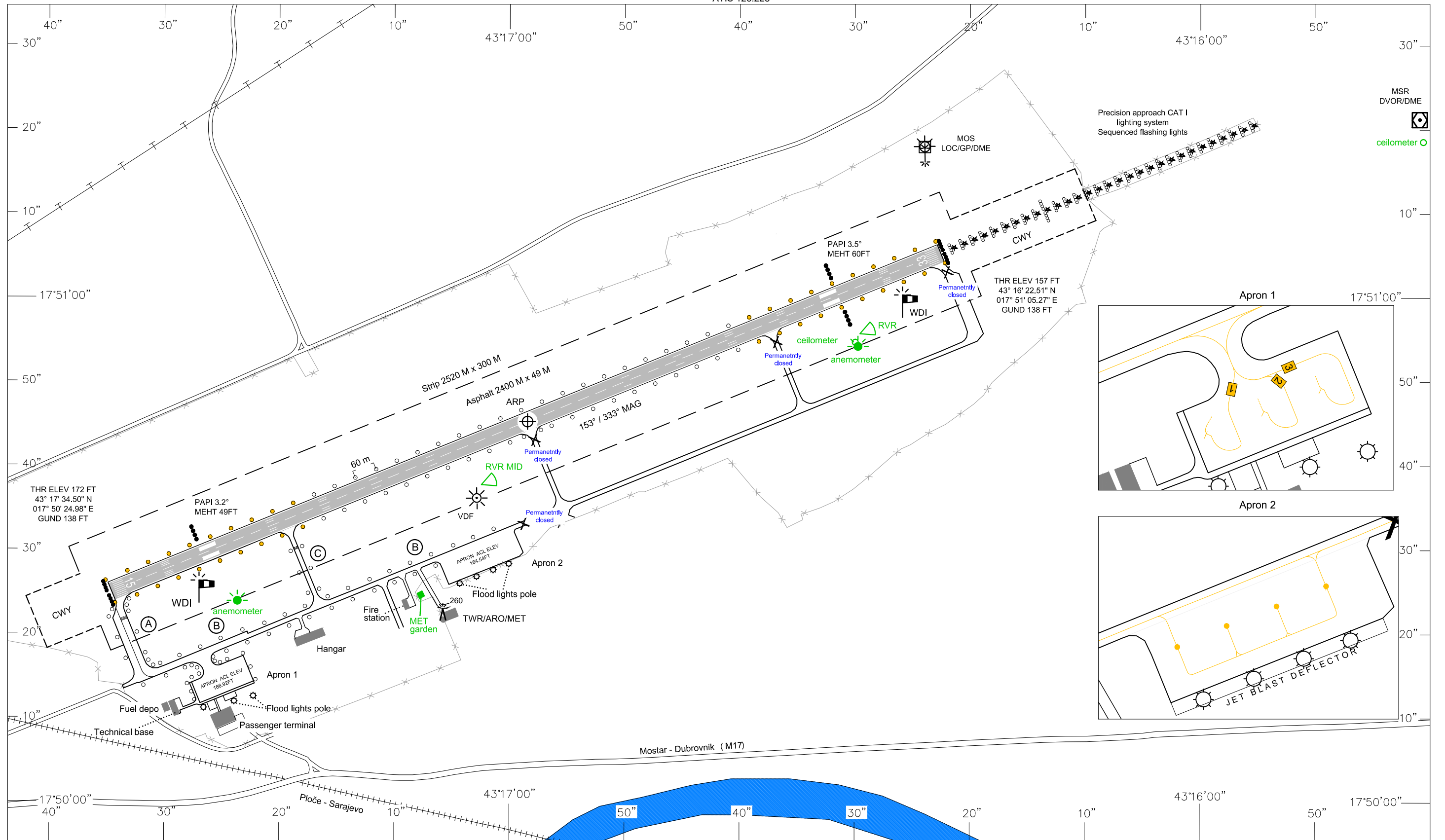

CHG: CORRECTED AIRPORT LAYOUT, ACL ELEVATION ADDED

APRON SURFACE, STRENGTH AND ELEVATION				
APRON	PSN	ASPH	PCN	ELEVATION
APRON 1	PSN 1	ASPH	PCN 50/R/B/W/U	50.88M/ 166.92FT
	PSN 2	ASPH	PCN 50/R/B/W/U	
	PSN 3	ASPH	PCN 70/R/B/W/U	
APRON 2	ALL PSN	CONC	PCN 44/R/B/W/U	50.15M/ 164.54FT

INTERSECTION TAKE-OFF				
RWY	INTERSEC	TORA (M)	TODA (M)	ASDA (M)
15	C	1900	2317	1900

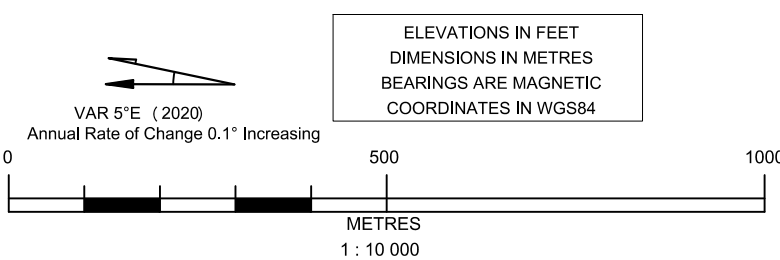

RWY	LIGHTING			DECLARED DISTANCES				PCN/SFC	BRG MAG
	APPROACH	RUNWAY	PAPI	TORA (M)	TODA (M)	ASDA (M)	LDA (M)		
15	NIL	HI	3.2°	2400	2817	2400	2400	PCN 54/R/B/X/T ASPH	153°
33	CAT I	HI	3.5°	2400	2619	2400	2400		333°

REMARK: PAPI RWY 33 indication LTD to a DIST of 6000M

THIS PAGE INTENTIONALLY LEFT BLANK